

NET PRICES

October 1, 2006
Prices F.O.B. Chattanooga

BAPTISTRIES

The suffix "W" following Model Number, designates "Window". In our brochure, all baptistries are illustrated with the factory - installed Window. **TO ORDER WITHOUT THE WINDOW, OMIT "W" FROM THE MODEL NUMBER.** (Omitting the Window always reduces the price - \$400.00)

100 SERIES

| | |
|------------------------------------|-----------|
| 101W | \$2100.00 |
| Without window - solid front | \$1700.00 |

200 SERIES

| | |
|------------------------------------|-----------|
| 201W | \$2000.00 |
| Without window - solid front | \$1600.00 |
| 202W, 203W | \$1900.00 |
| Without window - solid front | \$1500.00 |

S35 SERIES

| | |
|--|-----------|
| SL35W, SL35AW, SL35BW, SR35W, SR35AW, SR35BW | \$2000.00 |
| Without window - solid front | \$1600.00 |
| S35CW, S35DW, S35EW, S35FW, S35GW, S35HW, S35JW | \$2200.00 |
| Without window - solid front | \$1800.00 |

All viewing windows are factory installed

300 SERIES

| | |
|---|-----------|
| 302W, 303W | \$2000.00 |
| Without window - solid front | \$1600.00 |
| 302AW, 302CW, 302EW, 303BW, 303DW, 303FW | \$2200.00 |
| Without window - solid front | \$1800.00 |

350 SERIES

| | |
|--|-----------|
| 352W, 353W, 354W, 355W | \$2200.00 |
| Without window - solid front | \$1800.00 |
| 352AW, 352BW, 352CW, 353AW, 353BW, 353CW, 354AW, 354BW, 354CW, 355AW, 355BW, 355CW | \$2400.00 |
| Without window - solid front | \$2000.00 |

400 SERIES

| | |
|------------|-----------|
| 401W | \$3000.00 |
|------------|-----------|

ACCESSORIES

| | |
|---|----------|
| 6 Kilowatt Heater and Pump (Thermostatically - controlled: UL) (To be installed by customer.) | \$475.00 |
| 6 Kilowatt O-T-S Heater (Mounts on rim of Baptistry; thermostatically - controlled: UL) | \$425.00 |
| Automatic Water Level Control Unit | \$100.00 |
| Trip Lever Drain & Overflow Unit | \$100.00 |
| Child Step / Adult Seat | \$275.00 |
| Drip Catch Landing | \$200.00 |
| Plumbing Fitting Kit | \$100.00 |
| (1) 4" Floor Drain | 25.00 |
| (2) Overflow | 10.00 |
| (3) 1½" Shut-off Valve | 20.00 |
| (4) Fill Spout | 10.00 |
| (5) ½" Shut-off Valve | 10.00 |
| (6) Heater Hookup | 25.00 |

Prices and specifications subject to change without notice.

ALL VIEWING WINDOWS ARE FACTORY INSTALLED
20 YEAR WARRANTY • 100% FIBERGLASS • FREESTANDING
SKID RESISTANT STEPS AND FLOORS

BAPTISTRIES

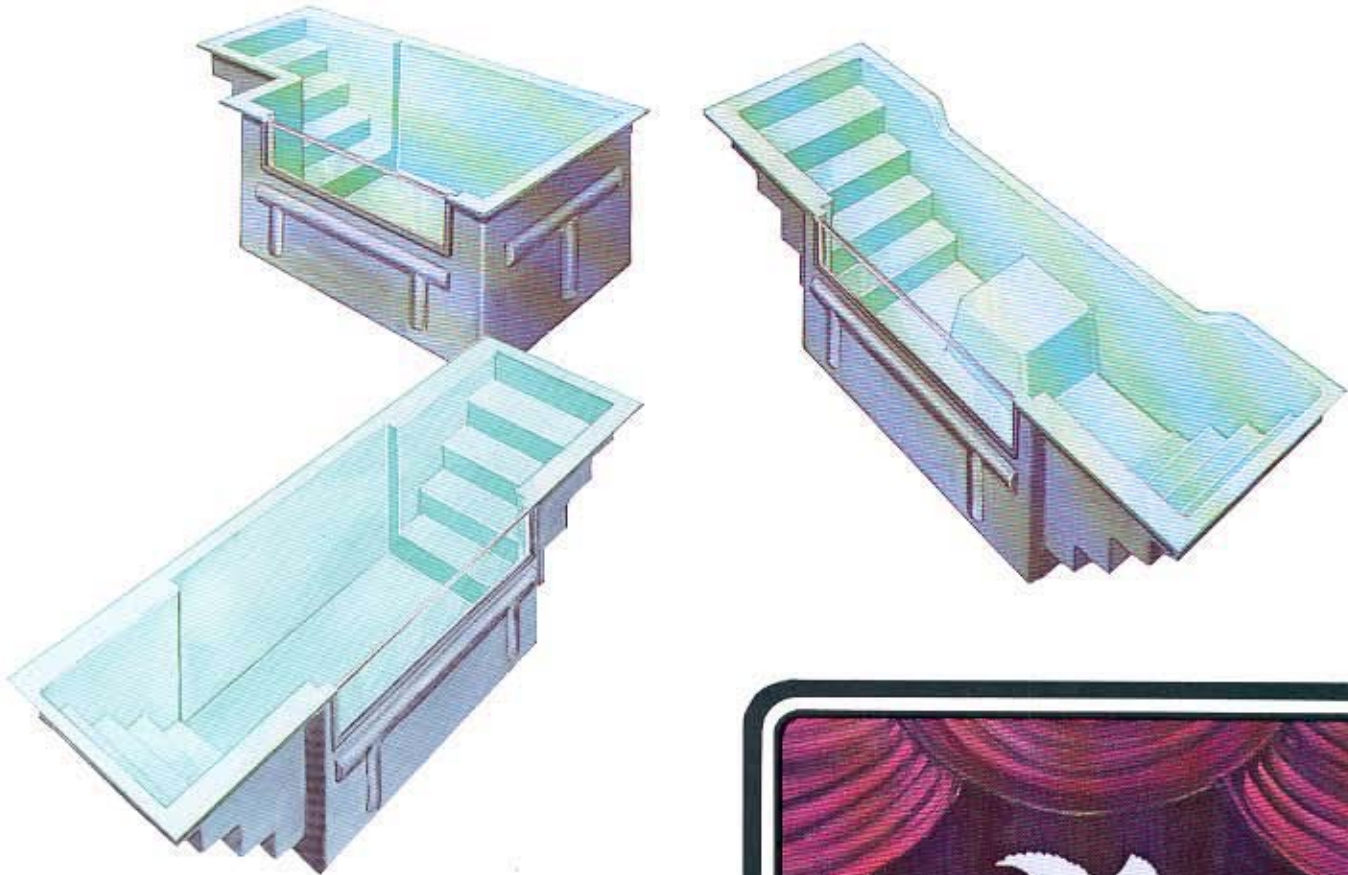

Truth Bookstore - Bowling Green, KY
1-800-428-0121

CEI Bookstore - Athens, AL
1-800-633-3216



ONE PIECE MOLDED FIBERGLASS BAPTISTRIES

Optional plexiglass window gives beauty and strength. A full 1/2" in thickness, will not yellow or craze. Tough, permanent seal eliminates leaks. All baptistries shown with window fronts. Any model (except 401W) may be ordered without window (designate model desired, omitting the "W" from the model number).

Wide range of baptistry models helps you select a size and shape to utilize available space effectively.

We are ready to help! Please write or call for further information.

- 20-YEAR LEAKPROOF WARRANTY
- GLEAMING PORCELAIN-LIKE FINISH
- ROUNDED CORNERS FOR SAFETY
- VIRTUALLY MAINTENANCE FREE
- NON-SKID STEPS AND BOTTOM
- EASILY INSTALLED OR RELOCATED
- FREE STANDING
- EASY PLUMBING
- LIGHTWEIGHT
- ECONOMICAL
- SHIPPED READY TO INSTALL
- AVAILABLE FROM STOCK

Truth Bookstore - Bowling Green, KY - 1-800-428-0121
CEI Bookstore - Athens, AL - 1-800-633-3216

100 Series

Weight: 275 Lbs.
Volume: 450 Gallons

BAPTISMAL CANDIDATE SITS
ON INTEGRAL-MOLDED
SEAT WHILE MINISTER
STANDS IN DRY AREA
BEHIND BAPTISTRY.

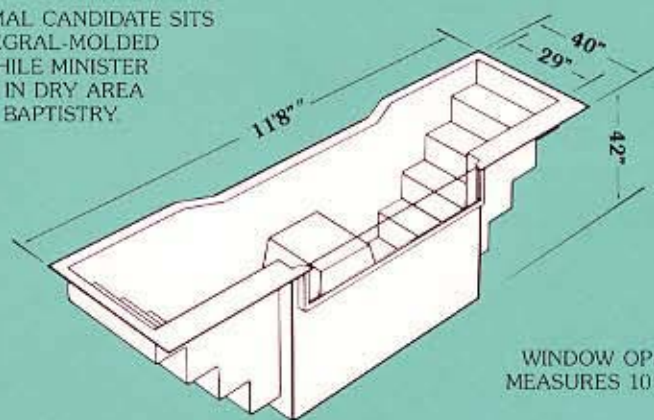

WINDOW OPENING
MEASURES 10" x 57"

TO ORDER BAPTISTRY WITHOUT WINDOW, OMIT THE "W" FROM THE STOCK NUMBER

200 Series

Weight: 300 Lbs.
Volume: 500 Gallons

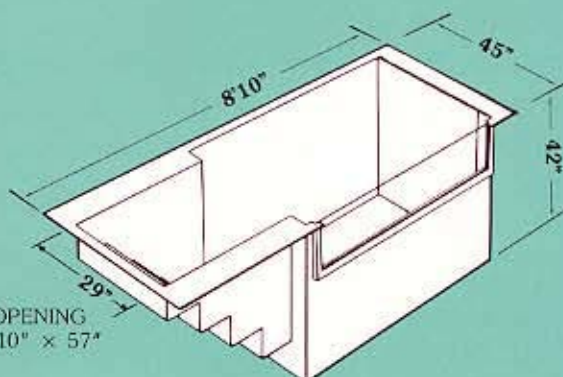
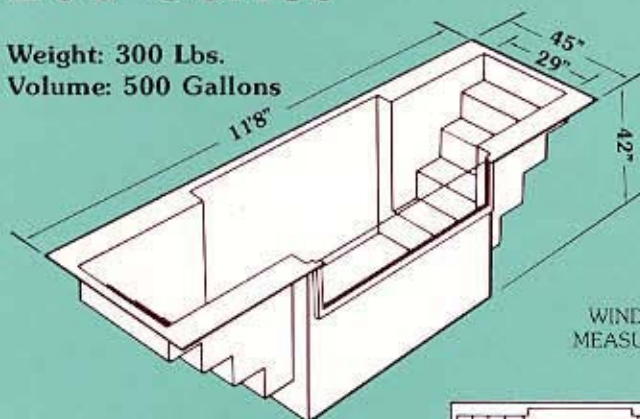

WINDOW OPENING
MEASURES 10" x 57"

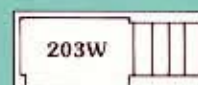
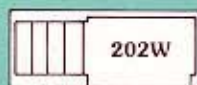
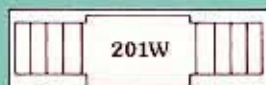

TO ORDER BAPTISTRY WITHOUT WINDOW, OMIT THE "W" FROM THE STOCK NUMBER

300 Series

Weight: 325 Lbs.
Volume: 675 Gallons

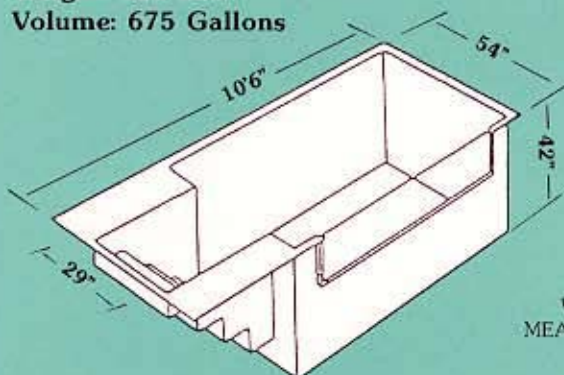

WINDOW OPENING
MEASURES 12 1/2" x 68 1/2"

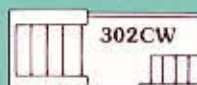
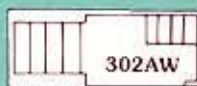
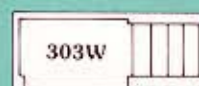
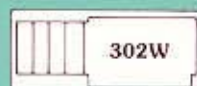

TO ORDER BAPTISTRY WITHOUT WINDOW, OMIT THE "W" FROM THE STOCK NUMBER

S35 Series

Weight: 300 Lbs.
Volume: 625 Gallons

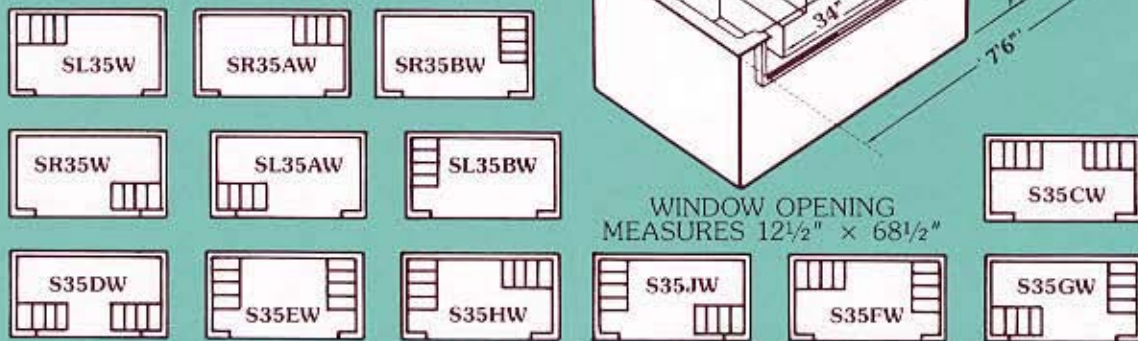

TO ORDER BAPTISTRY WITHOUT WINDOW, OMIT THE "W" FROM THE STOCK NUMBER

350 Series

Weight: 350 Lbs.
Volume: 725 Gallons

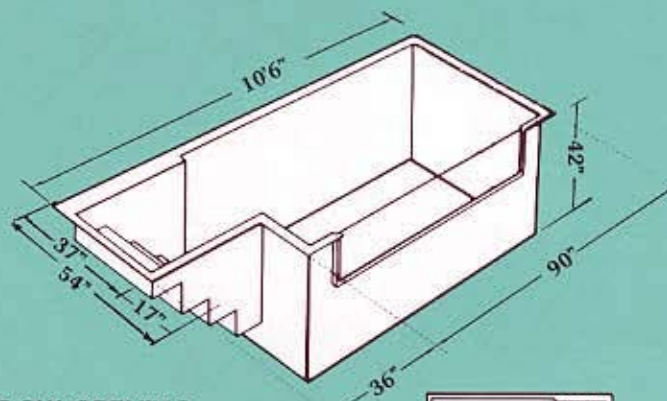

WINDOW OPENING
MEASURES 12 1/2" x 68 1/2"



TO ORDER BAPTISTRY WITHOUT WINDOW, OMIT THE "W" FROM THE STOCK NUMBER

400 Series

Weight: 450 Lbs.
Volume: 1000 Gallons

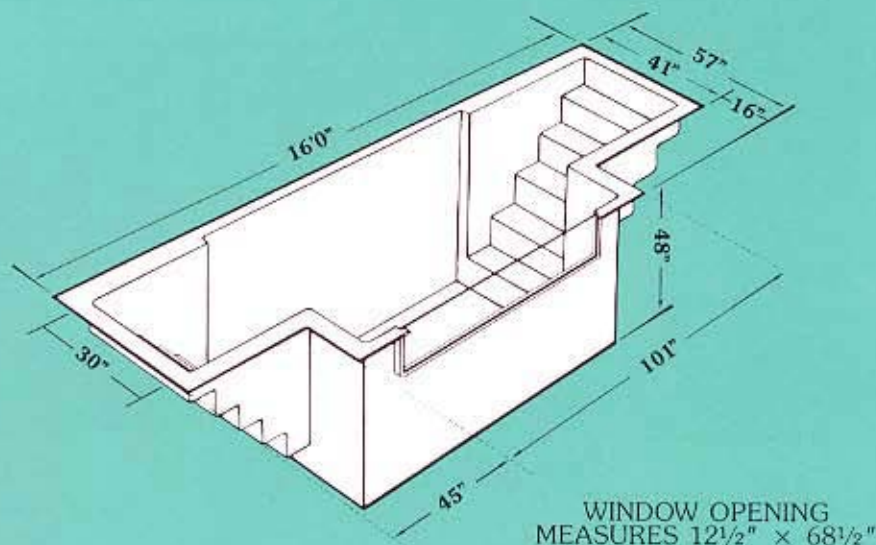
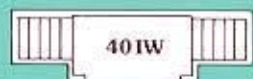

BAPTISTRY HEATING SYSTEMS

208 - 240 VOLTS:
ALL SYSTEMS

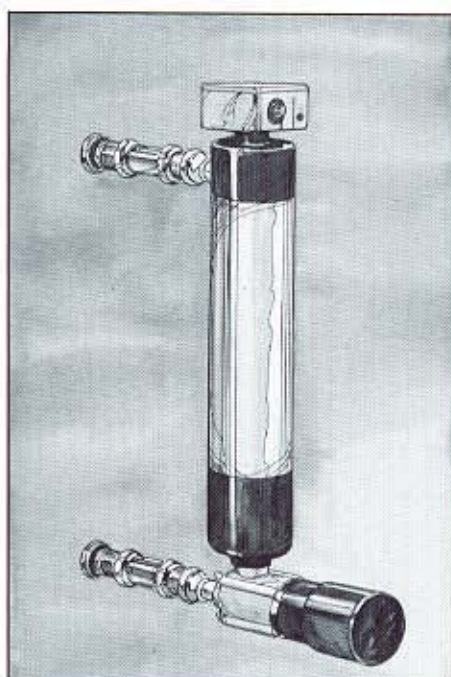

External Mount Water Heater

This is the recommended electric circulation baptistry heating system. A built in thermostat maintains any preset temperature, while the 230 volt water circulation pump provides even temperature and increases the efficiency of the heater. The heater and pump are wired in parallel, allowing them to operate simultaneously. Heaters available in 3, 5, or 6KW, 230 volt, single phase, UL, NSF.

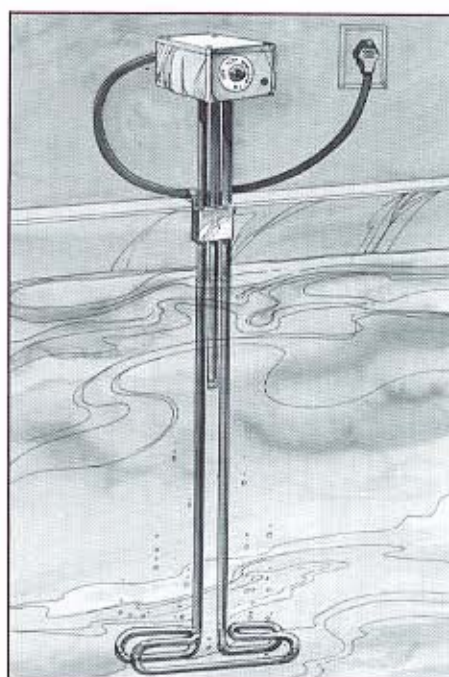

Over-the Side Heater

The Over-the-Side Heater is a complete, self-contained, thermostatically controlled water heater. This portable unit operates on 230 volt current and is equipped with thermostat, and on-off light. The 40" element extends into the water, and has adjustable stainless steel mounting brackets. 6KW, 230 volt, single phase, UL, NSF.

While considering the purchase of a baptistry, one should examine several important features that are sometimes overlooked. Costly mistakes are often discovered too late. After the unit has arrived on the job site is not the time to re-order the proper baptistry.



Examine our product and prices closely. A quality baptistry is not cheap, but few churches want a cheap product!

To order...for price quotation

FIBERGLASS CHURCH PRODUCTS

3511 Hixson Pike • Chattanooga, Tennessee 37415 • Toll Free 1-800-251-0679

Fax (423) 877-4240 • www.fiberglasschurchprod.com

SEE OUR EXCLUSIVE GUARANTEE!